

14M HTD®-GT®

**FORBORET
WITH PILOT BORE
VORGEBOHRT**

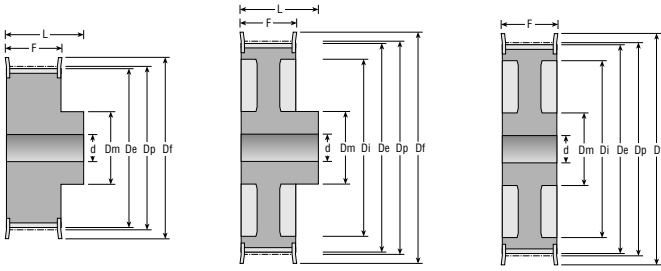

Figur 6F

Figur 6WF

Figur 10WF

Z	Rembr. Belt w. Riemenbr.	Mat.	Fig.	Best. nr. Part No. Best. Nr.	Dp	De	Df	Dm	Di	F	L	d	Vægt Weight Gewicht
28	40	GG	6F	02814M040N	124,78	122,12	127	100	-	54	69	24	4,73
	55	GG	6F	02814M055N	124,78	122,12	127	100	-	70	85	24	5,60
	85	GG	6F	02814M085N	124,78	122,12	127	100	-	102	117	24	7,70
	115	GG	6F	02814M115N	124,78	122,12	127	100	-	133	148	32	9,20
	170	GG	6F	02814M170N	124,78	122,12	127	100	-	187	202	32	13,80
29	40	GG	6F	02914M040N	129,23	126,57	138	100	-	54	69	24	5,09
	55	GG	6F	02914M055N	129,23	126,57	138	100	-	70	85	24	6,10
	85	GG	6F	02914M085N	129,23	126,57	138	100	-	102	117	24	8,40
	115	GG	6F	02914M115N	129,23	126,57	138	100	-	133	148	32	10,20
	170	GG	6F	02914M170N	129,23	126,57	138	100	-	187	202	32	14,20
30	40	GG	6F	03014M040N	133,69	130,99	138	100	-	54	69	24	5,45
	55	GG	6F	03014M055N	133,69	130,99	138	100	-	70	85	24	6,60
	85	GG	6F	03014M085N	133,69	130,99	138	100	-	102	117	24	9,10
	115	GG	6F	03014M115N	133,69	130,99	138	100	-	133	148	32	11,20
	170	GG	6F	03014M170N	133,69	130,99	138	100	-	187	202	32	15,60
32	40	GG	6F	03214M040N	142,60	139,88	154	100	-	54	69	24	6,17
	55	GG	6F	03214M055N	142,60	139,88	154	100	-	70	85	24	7,60
	85	GG	6F	03214M085N	142,60	139,88	154	100	-	102	117	24	10,50
	115	GG	6F	03214M115N	142,60	139,88	154	100	-	133	148	32	13,20
	170	GG	6F	03214M170N	142,60	139,88	154	100	-	187	202	32	18,10
34	40	GG	6F	03414M040N	151,52	148,79	160	100	-	54	69	24	6,88
	55	GG	6F	03414M055N	151,52	148,79	160	100	-	70	85	24	8,60
	85	GG	6F	03414M085N	151,52	148,79	160	100	-	102	117	24	11,90
	115	GG	6F	03414M115N	151,52	148,79	160	100	-	133	148	32	14,80
	170	GG	6F	03414M170N	151,52	148,79	160	100	-	187	202	32	20,40
36	40	GG	6F	03614M040N	160,43	157,68	168	100	-	54	69	24	7,60
	55	GG	6F	03614M055N	160,43	157,68	168	100	-	70	85	24	9,60
	85	GG	6F	03614M085N	160,43	157,68	168	100	-	102	117	32	13,20
	115	GG	6F	03614M115N	160,43	157,68	168	120	-	133	148	32	16,60
	170	GG	6F	03614M170N	160,43	157,68	168	120	-	187	202	32	23,50
38	40	GG	6F	03814M040N	169,34	166,60	183	120	-	54	69	24	8,28
	55	GG	6F	03814M055N	169,34	166,60	183	120	-	70	85	24	10,80
	85	GG	6F	03814M085N	169,34	166,60	183	120	-	102	117	32	15,15
	115	GG	6F	03814M115N	169,34	166,60	183	120	-	133	148	32	19,20
	170	GG	6F	03814M170N	169,34	166,60	183	135	-	187	202	32	26,50
40	40	GG	6F	04014M040N	178,25	175,49	188	120	-	54	69	24	9,26
	55	GG	6F	04014M055N	178,25	175,49	188	120	-	70	85	24	11,20
	85	GG	6F	04014M085N	178,25	175,49	188	135	-	102	117	32	17,10
	115	GG	6F	04014M115N	178,25	175,49	188	135	-	133	148	32	20,56
	170	GG	6F	04014M170N	178,25	175,49	188	140	-	187	202	32	30,10
44	40	GG	6F	04414M040N	196,08	193,28	211	120	-	54	69	24	10,32
	55	GG	6F	04414M055N	196,08	193,28	211	120	-	70	85	24	12,50
	85	GG	6F	04414M085N	196,08	193,28	211	135	-	102	117	32	23,30
	115	GG	6F	04414M115N	196,08	193,28	211	140	-	133	148	32	28,00
	170	GG	6F	04414M170N	196,08	193,28	211	160	-	187	202	32	37,80
48	40	GG	6WF	04814M040N	213,90	211,11	226	135	172	54	69	24	11,50
	55	GG	10WF	04814M055N	213,90	211,11	226	135	172	70	70	24	13,70
	85	GG	6F	04814M085N	213,90	211,11	226	150	-	102	117	32	25,00
	115	GG	6F	04814M115N	213,90	211,11	226	150	-	133	148	32	35,00
	170	GG	6F	04814M170N	213,90	211,11	226	160	-	187	202	32	44,50

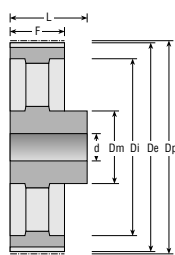

Figur 6A

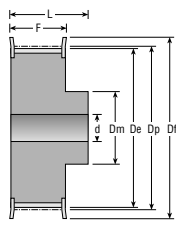

Figur 6F

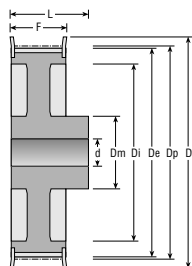

Figur 6WF

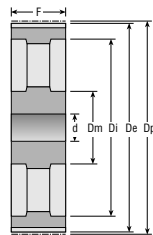

Figur 10A

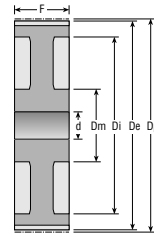

Figur 10W

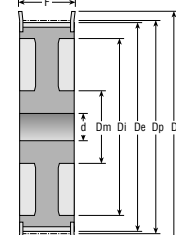

Figur 10WF

Z	Rembr. Belt w. Riemenbr.	Mat.	Fig.	Best. nr. Part No. Best. Nr.	Dp	De	Df	Dm	Di	F	L	d	Vægt Weight Gewicht
56	40	GG	6WF	05614M040N	249,55	246,76	256	135	207	54	69	28	13,05
	55	GG	10WF	05614M055N	249,55	246,76	256	135	207	70	70	28	14,50
	85	GG	10WF	05614M085N	249,55	246,76	256	150	207	102	102	32	25,00
	115	GG	6F	05614M115N	249,55	246,76	256	150	-	133	148	32	27,50
	170	GG	6F	05614M170N	249,55	246,76	256	160	-	187	202	32	61,00
64	40	GG	6WF	06414M040N	285,21	282,41	296	135	242	54	69	28	14,40
	55	GG	10WF	06414M055N	285,21	282,41	296	135	242	70	70	28	15,60
	85	GG	10WF	06414M085N	285,21	282,41	296	150	242	102	102	32	28,20
	115	GG	10WF	06414M115N	285,21	282,41	296	150	242	133	133	32	36,80
	170	GG	6F	06414M170N	285,21	282,41	296	180	-	187	202	32	81,00
72	40	GG	6A	07214M040N	320,86	318,06	-	135	278	54	69	28	16,90
	55	GG	10A	07214M055N	320,86	318,06	-	135	278	70	70	28	18,50
	85	GG	10A	07214M085N	320,86	318,06	-	150	278	102	102	32	28,80
	115	GG	10A	07214M115N	320,86	318,06	-	150	278	133	133	32	32,83
	170	GG	10W	07214M170N	320,86	318,06	-	180	278	187	187	32	61,40
80	40	GG	6A	08014M040N	356,51	353,71	-	135	314	54	69	28	18,50
	55	GG	10A	08014M055N	356,51	353,71	-	135	314	70	70	28	20,00
	85	GG	10A	08014M085N	356,51	353,71	-	150	314	102	102	32	30,10
	115	GG	10A	08014M115N	356,51	353,71	-	150	314	133	133	32	35,55
	170	GG	10W	08014M170N	356,51	353,71	-	180	314	187	187	32	65,00
90	40	GG	6A	09014M040N	401,07	398,28	-	135	358	54	69	28	20,00
	55	GG	10A	09014M055N	401,07	398,28	-	135	358	70	70	28	22,60
	85	GG	10A	09014M085N	401,07	398,28	-	150	358	102	102	32	33,00
	115	GG	10A	09014M115N	401,07	398,28	-	150	358	133	133	32	41,00
	170	GG	10A	09014M170N	401,07	398,28	-	180	358	187	187	38	68,00
112	40	GG	6A	11214M040N	499,11	496,32	-	135	456	54	69	28	26,70
	55	GG	10A	11214M055N	499,11	496,32	-	135	456	70	70	28	29,50
	85	GG	10A	11214M085N	499,11	496,32	-	150	456	102	102	32	41,80
	115	GG	10A	11214M115N	499,11	496,32	-	150	456	133	133	32	54,40
	170	GG	10A	11214M170N	499,11	496,32	-	200	456	187	187	38	87,50
144	40	GG	6A	14414M040N	641,71	638,92	-	135	600	54	69	28	35,00
	55	GG	10A	14414M055N	641,71	638,92	-	135	600	70	70	28	39,00
	85	GG	10A	14414M085N	641,71	638,92	-	150	600	102	102	32	52,40
	115	GG	10A	14414M115N	641,71	638,92	-	165	600	133	133	32	67,80
	170	GG	10A	14414M170N	641,71	638,92	-	220	600	187	187	38	114,80
168	40	GG	6A	16814M040N	748,66	745,87	-	135	706	54	69	28	44,20
	55	GG	10A	16814M055N	748,66	745,87	-	135	706	70	70	28	48,50
	85	GG	10A	16814M085N	748,66	745,87	-	150	706	102	102	32	60,30
	115	GG	10A	16814M115N	748,66	745,87	-	165	706	133	133	32	75,80
	170	GG	10A	16814M170N	748,66	745,87	-	220	706	187	187	38	125,00
192	40	GG	6A	19214M040N	855,62	852,82	-	135	813	54	69	28	52,20
	55	GG	10A	19214M055N	855,62	852,82	-	135	813	70	70	28	57,80
	85	GG	10A	19214M085N	855,62	852,82	-	165	813	102	102	32	70,20
	115	GG	10A	19214M115N	855,62	852,82	-	165	813	133	133	32	88,30
	170	GG	10A	19214M170N	855,62	852,82	-	220	813	187	187	38	136,40
216	40	GG	6A	21614M040N	962,57	959,76	-	150	920	54	69	28	60,00
	55	GG	10A	21614M055N	962,57	959,76	-	150	920	70	70	28	67,00
	85	GG	10A	21614M085N	962,57	959,76	-	165	920	102	102	32	81,00
	115	GG	10A	21614M115N	962,57	959,76	-	165	920	133	133	32	98,00
	170	GG	10A	21614M170N	962,57	959,76	-	220	920	187	187	38	147,00