

Figur 1F

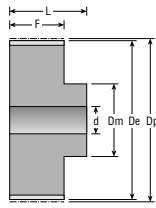

Figur 6

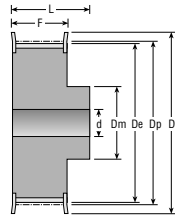

Figur 6F

Z	Rembr. Belt w. Riemenbr.	Mat.	Fig.	Best. nr. Part No. Best. Nr.	Dp	De	Df	Dm	Di	F	L	d	Vægt Weight Gewicht
10	9	AL	1F	0103M009N	9,55	8,79	13,0	13,0	-	10,2	17,5	-	0,004
	15	AL	1F	0103M015N	9,55	8,79	13,0	13,0	-	17,0	26,0	-	0,006
12	9	AL	1F	0123M009N	11,46	10,70	15,0	15,0	-	10,2	17,5	-	0,006
	15	AL	1F	0123M015N	11,46	10,70	15,0	15,0	-	17,0	26,0	-	0,008
14	9	AL	1F	0143M009N	13,37	12,61	16,0	16,0	-	10,2	17,5	-	0,007
	15	AL	1F	0143M015N	13,37	12,61	16,0	16,0	-	17,0	26,0	-	0,010
15	9	AL	1F	0153M009N	14,32	13,56	17,5	17,5	-	10,2	17,5	-	0,008
	15	AL	1F	0153M015N	14,32	13,56	17,5	17,5	-	17,0	26,0	-	0,012
16	9	AL	6F	0163M009N	15,28	14,52	18,0	9,5	-	12,8	20,6	4,0	0,007
	15	AL	6F	0163M015N	15,28	14,52	18,0	9,5	-	19,5	26,0	4,0	0,010
18	9	AL	6F	0183M009N	17,19	16,43	19,5	10,0	-	12,8	20,6	6,0	0,008
	15	AL	6F	0183M015N	17,19	16,43	19,5	10,0	-	19,5	26,0	6,0	0,012
20	9	AL	6F	0203M009N	19,10	18,34	23,0	12,0	-	12,8	20,6	6,0	0,010
	15	AL	6F	0203M015N	19,10	18,34	23,0	12,0	-	19,5	26,0	6,0	0,014
21	9	AL	6F	0213M009N	20,05	19,29	25,0	13,0	-	12,8	20,6	6,0	0,013
	15	AL	6F	0213M015N	20,05	19,29	25,0	13,0	-	19,5	26,0	6,0	0,016
22	9	AL	6F	0223M009N	21,01	20,25	25,0	13,0	-	12,8	20,6	6,0	0,014
	15	AL	6F	0223M015N	21,01	20,25	25,0	13,0	-	19,5	26,0	6,0	0,018
24	9	AL	6F	0243M009N	22,92	22,16	25,0	13,0	-	12,8	20,6	6,0	0,016
	15	AL	6F	0243M015N	22,92	22,16	25,0	13,0	-	19,5	26,0	6,0	0,020
26	9	AL	6F	0263M009N	24,83	24,07	28,0	16,0	-	12,8	20,6	6,0	0,018
	15	AL	6F	0263M015N	24,83	24,07	28,0	16,0	-	19,5	26,0	6,0	0,027
28	9	AL	6F	0283M009N	26,74	25,98	32,0	18,0	-	12,8	20,6	6,0	0,024
	15	AL	6F	0283M015N	26,74	25,98	32,0	18,0	-	19,5	26,0	6,0	0,030
30	9	AL	6F	0303M009N	28,65	27,89	32,0	19,0	-	12,8	20,6	6,0	0,028
	15	AL	6F	0303M015N	28,65	27,89	32,0	19,0	-	19,5	26,0	6,0	0,035
32	9	AL	6F	0323M009N	30,56	29,80	36,0	22,0	-	12,8	20,6	6,0	0,032
	15	AL	6F	0323M015N	30,56	29,80	36,0	22,0	-	19,5	26,0	6,0	0,042
36	9	AL	6F	0363M009N	34,38	33,62	38,0	26,0	-	13,4	22,2	6,0	0,045
	15	AL	6F	0363M015N	34,38	33,62	38,0	26,0	-	20,0	30,0	6,0	0,060
40	9	AL	6F	0403M009N	38,20	37,44	42,0	28,0	-	13,4	22,2	6,0	0,055
	15	AL	6F	0403M015N	38,20	37,44	42,0	28,0	-	20,0	30,0	6,0	0,075
44	9	AL	6F	0443M009N	42,02	41,26	48,0	33,0	-	13,4	22,2	6,0	0,074
	15	AL	6F	0443M015N	42,02	41,26	48,0	33,0	-	20,0	30,0	6,0	0,100
48	9	AL	6	0483M009N	45,84	45,08	-	33,0	-	13,4	22,2	8,0	0,074
	15	AL	6	0483M015N	45,84	45,08	-	33,0	-	20,0	30,0	8,0	0,103
60	9	AL	6	0603M009N	57,30	56,54	-	33,0	-	13,4	22,2	8,0	0,106
	15	AL	6	0603M015N	57,30	56,54	-	33,0	-	20,0	30,0	8,0	0,150
72	9	AL	6	0723M009N	68,75	67,99	-	33,0	-	13,4	22,2	8,0	0,145
	15	AL	6	0723M015N	68,75	67,99	-	33,0	-	20,0	30,0	8,0	0,212

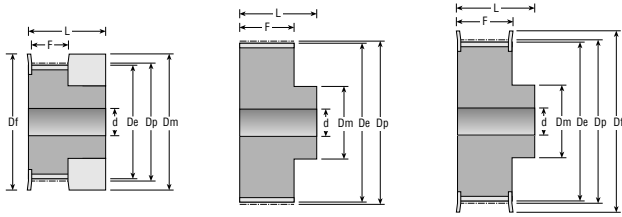

Figur 1F

Figur 6

Figur 6F

Z	Rembr. Belt w. Riemenbr.	Mat.	Fig.	Best. nr. Part No. Best. Nr.	Dp	De	Df	Dm	Di	F	L	d	Vægt Weight Gewicht
10	9	AL	1F	0103MR009N	9,55	8,79	13,0	13,0	-	10,2	17,5	-	0,004
	15	AL	1F	0103MR015N	9,55	8,79	13,0	13,0	-	17,0	26,0	-	0,006
12	9	AL	1F	0123MR009N	11,46	10,70	15,0	15,0	-	10,2	17,5	-	0,006
	15	AL	1F	0123MR015N	11,46	10,70	15,0	15,0	-	17,0	26,0	-	0,008
14	9	AL	1F	0143MR009N	13,37	12,61	16,0	16,0	-	10,2	17,5	-	0,007
	15	AL	1F	0143MR015N	13,37	12,61	16,0	16,0	-	17,0	26,0	-	0,010
15	9	AL	1F	0153MR009N	14,32	13,56	17,5	17,5	-	10,2	17,5	-	0,008
	15	AL	1F	0153MR015N	14,32	13,56	17,5	17,5	-	17,0	26,0	-	0,012
16	9	AL	6F	0163MR009N	15,28	14,52	18,0	9,5	-	12,8	20,6	4,0	0,007
	15	AL	6F	0163MR015N	15,28	14,52	18,0	9,5	-	19,5	26,0	4,0	0,010
18	9	AL	6F	0183MR009N	17,19	16,43	19,5	10,0	-	12,8	20,6	6,0	0,008
	15	AL	6F	0183MR015N	17,19	16,43	19,5	10,0	-	19,5	26,0	6,0	0,012
20	9	AL	6F	0203MR009N	19,10	18,34	23,0	12,0	-	12,8	20,6	6,0	0,010
	15	AL	6F	0203MR015N	19,10	18,34	23,0	12,0	-	19,5	26,0	6,0	0,014
21	9	AL	6F	0213MR009N	20,05	19,29	25,0	13,0	-	12,8	20,6	6,0	0,013
	15	AL	6F	0213MR015N	20,05	19,29	25,0	13,0	-	19,5	26,0	6,0	0,016
22	9	AL	6F	0223MR009N	21,01	20,25	25,0	13,0	-	12,8	20,6	6,0	0,014
	15	AL	6F	0223MR015N	21,01	20,25	25,0	13,0	-	19,5	26,0	6,0	0,018
24	9	AL	6F	0243MR009N	22,92	22,16	25,0	13,0	-	12,8	20,6	6,0	0,016
	15	AL	6F	0243MR015N	22,92	22,16	25,0	13,0	-	19,5	26,0	6,0	0,020
26	9	AL	6F	0263MR009N	24,83	24,07	28,0	16,0	-	12,8	20,6	6,0	0,018
	15	AL	6F	0263MR015N	24,83	24,07	28,0	16,0	-	19,5	26,0	6,0	0,027
28	9	AL	6F	0283MR009N	26,74	25,98	32,0	18,0	-	12,8	20,6	6,0	0,024
	15	AL	6F	0283MR015N	26,74	25,98	32,0	18,0	-	19,5	26,0	6,0	0,030
30	9	AL	6F	0303MR009N	28,65	27,89	32,0	19,0	-	12,8	20,6	6,0	0,028
	15	AL	6F	0303MR015N	28,65	27,89	32,0	19,0	-	19,5	26,0	6,0	0,035
32	9	AL	6F	0323MR009N	30,56	29,80	36,0	22,0	-	12,8	20,6	6,0	0,032
	15	AL	6F	0323MR015N	30,56	29,80	36,0	22,0	-	19,5	26,0	6,0	0,042
36	9	AL	6F	0363MR009N	34,38	33,62	38,0	26,0	-	13,4	22,2	6,0	0,045
	15	AL	6F	0363MR015N	34,38	33,62	38,0	26,0	-	20,0	30,0	6,0	0,060
40	9	AL	6F	0403MR009N	38,20	37,44	42,0	28,0	-	13,4	22,2	6,0	0,055
	15	AL	6F	0403MR015N	38,20	37,44	42,0	28,0	-	20,0	30,0	6,0	0,075
44	9	AL	6F	0443MR009N	42,02	41,26	48,0	33,0	-	13,4	22,2	6,0	0,074
	15	AL	6F	0443MR015N	42,02	41,26	48,0	33,0	-	20,0	30,0	6,0	0,100
48	9	AL	6	0483MR009N	45,84	45,08	-	33,0	-	13,4	22,2	8,0	0,074
	15	AL	6	0483MR015N	45,84	45,08	-	33,0	-	20,0	30,0	8,0	0,103
60	9	AL	6	0603MR009N	57,30	56,54	-	33,0	-	13,4	22,2	8,0	0,106
	15	AL	6	0603MR015N	57,30	56,54	-	33,0	-	20,0	30,0	8,0	0,150
72	9	AL	6	0723MR009N	68,75	67,99	-	33,0	-	13,4	22,2	8,0	0,145
	15	AL	6	0723MR015N	68,75	67,99	-	33,0	-	20,0	30,0	8,0	0,212