

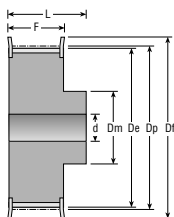

B2

# 8M HTD®-GT®

## FORBORET WITH PILOT BORE VORGEBOHRT



Figur 6F

Z	Rembr. Belt w. Riemenbr.	Mat.	Fig.	Best. nr. Part No. Best. Nr.	Dp	De	Df	Dm	Di	F	L	d	Vægt Weight Gewicht
22	20	ST	6F	0228M020N	56,02	54,65	60,0	43	-	28	38	12	0,54
	30	ST	6F	0228M030N	56,02	54,65	60,0	43	-	38	48	12	0,69
	50	ST	6F	0228M050N	56,02	54,65	60,0	43	-	60	70	12	1,00
	85	ST	6F	0228M085N	56,02	54,65	60,0	43	-	95	105	12	1,55
24	20	ST	6F	0248M020N	61,12	59,75	66,0	45	-	28	38	12	0,65
	30	ST	6F	0248M030N	61,12	59,75	66,0	45	-	38	48	12	0,84
	50	ST	6F	0248M050N	61,12	59,75	66,0	45	-	60	70	12	1,23
	85	ST	6F	0248M085N	61,12	59,75	66,0	45	-	95	105	12	1,90
26	20	ST	6F	0268M020N	66,21	64,84	71,0	50	-	28	38	12	0,80
	30	ST	6F	0268M030N	66,21	64,84	71,0	50	-	38	48	12	1,00
	50	ST	6F	0268M050N	66,21	64,84	71,0	50	-	60	70	12	1,50
	85	ST	6F	0268M085N	66,21	64,84	71,0	50	-	95	105	12	2,25
28	20	ST	6F	0288M020N	71,30	70,08	75,0	50	-	28	38	15	0,87
	30	ST	6F	0288M030N	71,30	70,08	75,0	50	-	38	48	15	1,12
	50	ST	6F	0288M050N	71,30	70,08	75,0	50	-	60	70	15	1,67
	85	ST	6F	0288M085N	71,30	70,08	75,0	50	-	95	105	15	2,55
30	20	ST	6F	0308M020N	76,39	75,13	83,0	55	-	28	38	15	1,02
	30	ST	6F	0308M030N	76,39	75,13	83,0	55	-	38	48	15	1,32
	50	ST	6F	0308M050N	76,39	75,13	83,0	55	-	60	70	15	1,97
	85	ST	6F	0308M085N	76,39	75,13	83,0	55	-	95	105	15	3,00
32	20	ST	6F	0328M020N	81,49	80,16	87,0	60	-	28	38	15	1,20
	30	ST	6F	0328M030N	81,49	80,16	87,0	60	-	38	48	15	1,53
	50	ST	6F	0328M050N	81,49	80,16	87,0	60	-	60	70	15	2,27
	85	ST	6F	0328M085N	81,49	80,16	87,0	60	-	95	105	15	3,57
34	20	ST	6F	0348M020N	86,58	85,22	91,0	70	-	28	38	15	1,40
	30	ST	6F	0348M030N	86,58	85,22	91,0	70	-	38	48	15	1,80
	50	ST	6F	0348M050N	86,58	85,22	91,0	70	-	60	70	15	2,69
	85	ST	6F	0348M085N	86,58	85,22	91,0	70	-	95	105	15	4,00
36	20	ST	6F	0368M020N	91,67	90,30	98,5	70	-	28	38	15	1,55
	30	ST	6F	0368M030N	91,67	90,30	98,5	70	-	38	48	15	1,99
	50	ST	6F	0368M050N	91,67	90,30	98,5	70	-	60	70	15	2,97
	85	ST	6F	0368M085N	91,67	90,30	98,5	70	-	95	105	15	4,50
38	20	ST	6F	0388M020N	96,77	95,39	103,0	75	-	28	38	15	1,65
	30	ST	6F	0388M030N	96,77	95,39	103,0	75	-	38	48	15	2,27
	50	ST	6F	0388M050N	96,77	95,39	103,0	75	-	60	70	15	3,23
	85	ST	6F	0388M085N	96,77	95,39	103,0	75	-	95	105	15	4,90
40	20	GG	6F	0408M020N	101,86	100,49	106,0	75	-	28	38	15	1,74
	30	GG	6F	0408M030N	101,86	100,49	106,0	75	-	38	48	15	2,40
	50	GG	6F	0408M050N	101,86	100,49	106,0	75	-	60	70	18	3,50
	85	GG	6F	0408M085N	101,86	100,49	106,0	75	-	95	105	18	5,20
44	20	GG	6F	0448M020N	112,05	110,67	119,0	75	-	28	38	15	2,10
	30	GG	6F	0448M030N	112,05	110,67	119,0	75	-	38	48	15	2,80
	50	GG	6F	0448M050N	112,05	110,67	119,0	75	-	60	70	18	3,90
	85	GG	6F	0448M085N	112,05	110,67	119,0	75	-	95	105	18	6,60

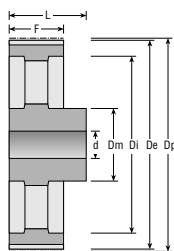

Figur 6A

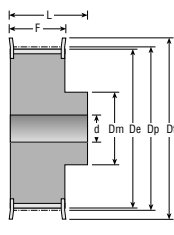

Figur 6F

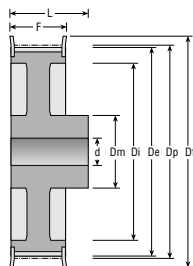

Figur 6WF

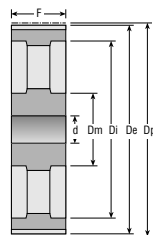

Figur 10A

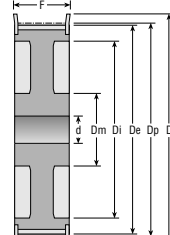

Figur 10WF

Z	Rembr. Belt w. Riemenbr.	Mat.	Fig.	Best. nr. Part No. Best. Nr.	Dp	De	Df	Dm	Di	F	L	d	Vægt Weight Gewicht
48	20	GG	6F	0488M020N	122,23	120,86	127,0	75	-	28	38	15	2,44
	30	GG	6F	0488M030N	122,23	120,86	127,0	75	-	38	48	15	3,20
	50	GG	6F	0488M050N	122,23	120,86	127,0	80	-	60	70	18	4,30
	85	GG	6F	0488M085N	122,23	120,86	127,0	80	-	95	105	18	7,60
56	20	GG	6WF	0568M020N	142,60	141,23	148,0	80	117	28	38	15	2,60
	30	GG	6WF	0568M030N	142,60	141,23	148,0	90	117	38	48	15	3,60
	50	GG	10WF	0568M050N	142,60	141,23	148,0	90	117	60	60	18	5,00
	85	GG	6F	0568M085N	142,60	141,23	148,0	80	-	95	105	20	9,80
64	20	GG	6WF	0648M020N	162,97	161,60	168,0	80	137	28	38	15	2,90
	30	GG	6WF	0648M030N	162,97	161,60	168,0	90	137	38	48	15	4,30
	50	GG	10WF	0648M050N	162,97	161,60	168,0	100	137	60	60	18	5,60
	85	GG	10WF	0648M085N	162,97	161,60	168,0	100	137	95	95	20	10,40
72	20	GG	6WF	0728M020N	183,35	181,97	192,0	80	158	28	38	15	3,10
	30	GG	6WF	0728M030N	183,35	181,97	192,0	95	158	38	48	15	4,80
	50	GG	10WF	0728M050N	183,35	181,97	192,0	100	158	60	60	18	6,80
	85	GG	10WF	0728M085N	183,35	181,97	192,0	110	158	95	95	20	11,40
80	20	GG	6A	0808M020N	203,72	202,35	-	90	180	28	38	15	3,80
	30	GG	6A	0808M030N	203,72	202,35	-	100	180	38	48	15	5,10
	50	GG	10A	0808M050N	203,72	202,35	-	110	180	60	60	18	6,90
	85	GG	10A	0808M085N	203,72	202,35	-	110	180	95	95	20	11,10
90	20	GG	6A	0908M020N	229,18	227,81	-	90	204	28	38	15	4,20
	30	GG	6A	0908M030N	229,18	227,81	-	100	204	38	48	15	5,70
	50	GG	10A	0908M050N	229,18	227,81	-	110	204	60	60	18	8,60
	85	GG	10A	0908M085N	229,18	227,81	-	110	204	95	95	20	13,20
112	20	GG	6A	1128M020N	285,21	283,83	-	90	260	28	38	18	5,20
	30	GG	6A	1128M030N	285,21	283,83	-	100	260	38	48	18	6,80
	50	GG	10A	1128M050N	285,21	283,83	-	110	260	60	60	18	9,60
	85	GG	10A	1128M085N	285,21	283,83	-	110	260	95	95	24	16,30
144	20	GG	6A	1448M020N	366,69	365,32	-	90	341	28	38	20	7,50
	30	GG	6A	1448M030N	366,69	365,32	-	100	341	38	48	20	9,30
	50	GG	10A	1448M050N	366,69	365,32	-	110	341	60	60	20	13,80
	85	GG	10A	1448M085N	366,69	365,32	-	120	341	95	95	24	21,50
168	20	GG	6A	1688M020N	427,81	426,44	-	100	402	28	38	20	10,00
	30	GG	6A	1688M030N	427,81	426,44	-	100	402	38	48	20	11,40
	50	GG	10A	1688M050N	427,81	426,44	-	120	402	60	60	20	16,00
	85	GG	10A	1688M085N	427,81	426,44	-	120	402	95	95	24	26,10
192	20	GG	6A	1928M020N	488,92	487,55	-	100	463	28	38	20	14,40
	30	GG	6A	1928M030N	488,92	487,55	-	100	463	38	48	20	16,00
	50	GG	10A	1928M050N	488,92	487,55	-	130	463	60	60	20	22,40
	85	GG	10A	1928M085N	488,92	487,55	-	130	463	95	95	24	30,60