



# H

**BI**

## 1/2" (12,7 mm)

### FOR TAPER BØSNINGER FOR TAPER BUSHES FÜR TAPER BUCHSEN

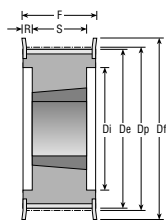

Figur 4F

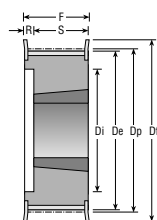

Figur 5F

Z	Rembr. Belt w. Riemenbr.	Mat.	Fig.	Best. nr. Part No. Best. Nr.	Bush	Dp	De	Df	Dm	Di	F	S	R	Vægt Weight Gewicht
16	100	ST	5F	016H100T	1108	64,68	63,31	71	-	45	31	22	9,0	0,4
18	100	ST	5F	018H100T	1210	72,77	71,39	79	-	52	31	25	6,0	0,5
	150	ST	5F	018H150T	1210	72,77	71,39	79	-	53	45	25	20,0	0,6
	200	ST	5F	018H200T	1210	72,77	71,39	79	-	52	58	25	33,0	0,8
19	100	ST	5F	019H100T	1210	76,81	75,44	83	-	56	31	25	6,0	0,6
	150	ST	5F	019H150T	1210	76,81	75,44	83	-	56	45	25	20,0	0,7
	200	ST	5F	019H200T	1610	76,81	75,44	83	-	56	58	25	33,0	0,9
20	100	ST	5F	020H100T	1210	80,55	79,48	87	-	60	31	25	6,0	0,7
	150	ST	5F	020H150T	1210	80,55	79,48	87	-	60	45	25	20,0	0,8
	200	ST	5F	020H200T	1610	80,55	79,48	87	-	60	58	25	33,0	1,0
	300	ST	4F	020H300T	1615	80,55	79,48	87	-	65	84	38	23,0	1,5
21	100	GG	5F	021H100T	1210	84,89	83,52	91	-	63	32	25	7,0	0,8
	150	GG	5F	021H150T	1210	84,89	83,52	91	-	64	45	25	20,0	1,0
	200	GG	5F	021H200T	1610	84,89	83,52	91	-	64	58	25	33,0	1,7
	300	GG	4F	021H300T	1615	84,89	83,52	91	-	66	84	38	23,0	1,2
22	100	GG	5F	022H100T	1210	88,94	87,56	93	-	67	32	25	7,0	0,9
	150	GG	5F	022H150T	1210	88,94	87,56	93	-	68	45	25	20,0	1,2
	200	GG	5F	022H200T	1610	88,94	87,56	93	-	68	58	25	33,0	1,5
	300	GG	4F	022H300T	1615	88,94	87,56	93	-	67	84	38	23,0	1,6
23	100	GG	5F	023H100T	1610	92,98	91,61	97	-	71	32	25	7,0	0,9
	150	GG	5F	023H150T	1610	92,98	91,61	97	-	71	45	25	20,0	1,3
	200	GG	5F	023H200T	1610	92,98	91,61	97	-	71	58	25	33,0	1,8
	300	GG	4F	023H300T	1615	92,98	91,61	97	-	71	84	38	23,0	1,8
24	100	GG	5F	024H100T	1610	97,02	95,65	103	-	75	32	25	7,0	1,0
	150	GG	5F	024H150T	1610	97,02	95,65	103	-	74	45	25	20,0	1,2
	200	GG	5F	024H200T	1610	97,02	95,65	103	-	74	58	25	33,0	1,5
	300	GG	4F	024H300T	1615	97,02	95,65	103	-	75	84	38	23,0	2,1
25	100	GG	5F	025H100T	1610	101,06	99,69	106	-	79	32	25	7,0	1,0
	150	GG	5F	025H150T	1610	101,06	99,69	106	-	78	45	25	20,0	1,2
	200	GG	5F	025H200T	1610	101,06	99,69	106	-	78	58	25	33,0	1,5
	300	GG	4F	025H300T	1615	101,06	99,69	106	-	79	84	38	23,0	2,0
26	100	GG	5F	026H100T	1610	105,11	103,73	111	-	83	32	25	7,0	1,2
	150	GG	5F	026H150T	1610	105,11	103,73	111	-	82	45	25	20,0	1,4
	200	GG	5F	026H200T	1610	105,11	103,73	111	-	82	58	25	33,0	1,8
	300	GG	4F	026H300T	1615	105,11	103,73	111	-	83	84	38	23,0	2,7
27	100	GG	5F	027H100T	1610	109,15	107,78	115	-	87	32	25	7,0	1,3
	150	GG	5F	027H150T	1610	109,15	107,78	115	-	87	45	25	20,0	1,6
	200	GG	5F	027H200T	1610	109,15	107,78	115	-	87	58	25	33,0	1,9
	300	GG	4F	027H300T	2012	109,15	107,78	115	-	87	84	32	26,0	3,0
28	100	GG	5F	028H100T	1610	113,19	111,82	119	-	91	32	25	7,0	1,5
	150	GG	5F	028H150T	1610	113,19	111,82	119	-	91	45	25	20,0	1,8
	200	GG	5F	028H200T	1610	113,19	111,82	119	-	91	58	25	33,0	1,9
	300	GG	4F	028H300T	2012	113,19	111,82	119	-	91	84	32	26,0	2,4

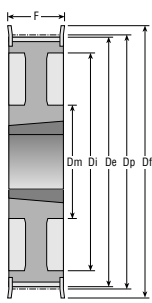

Figur 3WF

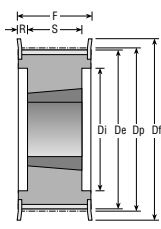

Figur 4F

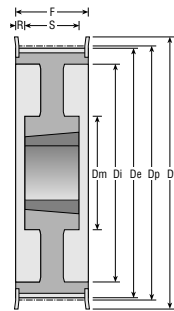

Figur 4WF/9WF

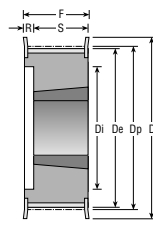

Figur 5F

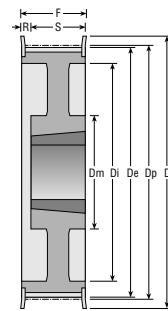

Figur 5WF

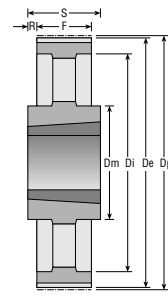

Figur 7A

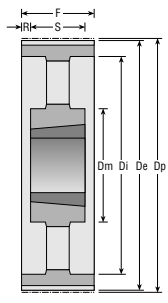

Figur 9A

Z	Rembr. Belt w. Riemenbr.	Mat.	Fig.	Best. nr. Part No. Best. Nr.	Bush	Dp	De	Df	Dm	Di	F	S	R	Vægt Weight Gewicht
30	100	GG	5F	030H100T	1610	121,28	119,90	127	-	99	32	25	7,0	1,7
	150	GG	5F	030H150T	1610	121,28	119,90	127	-	99	45	25	20,0	2,0
	200	GG	5F	030H200T	1610	121,28	119,90	127	-	99	58	25	33,0	2,3
	300	GG	4F	030H300T	2012	121,28	119,90	127	-	99	84	32	26,0	2,9
32	100	GG	5WF	032H100T	1610	129,36	127,99	135	92	108	32	25	7,0	2,0
	150	GG	5WF	032H150T	1610	129,36	127,99	135	92	108	45	25	20,0	2,3
	200	GG	5F	032H200T	2012	129,36	127,99	135	-	107	58	32	26,0	3,0
	300	GG	4F	032H300T	2517	129,36	127,99	135	-	107	84	45	19,5	3,3
36	100	GG	5WF	036H100T	1610	145,53	144,16	152	92	124	32	25	7,0	2,7
	150	GG	5WF	036H150T	1610	145,53	144,16	152	92	124	45	25	20,0	3,1
	200	GG	5WF	036H200T	2012	145,53	144,16	152	102	124	58	32	26,0	3,0
	300	GG	4F	036H300T	2517	145,53	144,16	152	-	124	84	45	19,5	4,5
40	100	GG	5WF	040H100T	1610	161,70	160,33	168	92	140	32	25	7,0	3,6
	150	GG	5WF	040H150T	1610	161,70	160,33	168	92	140	45	25	20,0	4,0
	200	GG	5WF	040H200T	2012	161,70	160,33	168	106	140	58	32	26,0	3,6
	300	GG	4F	040H300T	2517	161,70	160,33	168	-	137	84	45	19,5	6,0
44	100	GG	3WF	044H100T	2012	177,87	176,50	184	106	153	32	32	-	3,8
	150	GG	5WF	044H150T	2012	177,87	176,50	184	106	153	45	32	13,0	3,6
	200	GG	5WF	044H200T	2012	177,87	176,50	184	106	153	58	32	26,0	4,5
	300	GG	4WF	044H300T	2517	177,87	176,50	184	119	153	86	45	20,5	6,6
48	100	GG	3WF	048H100T	2012	194,04	192,67	200	106	169	32	32	-	3,2
	150	GG	5WF	048H150T	2012	194,04	192,67	200	106	169	45	32	13,0	4,8
	200	GG	5WF	048H200T	2517	194,04	192,67	200	119	169	58	45	13,0	4,6
	300	GG	4WF	048H300T	2517	194,04	192,67	200	119	169	86	45	20,5	7,6
60	100	GG	9A	060H100T	2012	242,55	241,18	-	106	223	34	32	1,0	4,8
	150	GG	9A	060H150T	2012	242,55	241,18	-	106	223	46	32	7,0	5,4
	200	GG	9A	060H200T	2517	242,55	241,18	-	119	223	60	45	7,5	7,0
	300	GG	9A	060H300T	2517	242,55	241,18	-	119	223	86	45	20,5	8,4
72	100	GG	9A	072H100T	2012	291,06	289,69	-	106	270	34	32	1,0	5,7
	150	GG	9A	072H150T	2012	291,06	289,69	-	106	270	46	32	7,0	6,5
	200	GG	9A	072H200T	2517	291,06	289,69	-	119	270	60	45	7,5	8,0
	300	GG	9A	072H300T	2517	291,06	289,69	-	119	270	86	45	20,5	10,4
84	100	GG	9A	084H100T	2012	339,57	338,20	-	106	318	34	32	1,0	6,8
	150	GG	9A	084H150T	2012	339,57	338,20	-	106	320	46	32	7,0	8,4
	200	GG	9A	084H200T	2517	339,57	338,20	-	119	320	60	45	7,5	9,0
	300	GG	9A	084H300T	2517	339,57	338,20	-	119	320	86	45	20,5	12,5
96	100	GG	7A	096H100T	2517	388,08	386,71	-	119	366	34	45	5,5	8,2
	150	GG	9A	096H150T	2517	388,08	386,71	-	119	366	46	45	0,5	10,2
	200	GG	9A	096H200T	2517	388,08	386,71	-	119	366	60	45	7,5	11,5
	300	GG	9A	096H300T	3030	388,08	386,71	-	150	362	86	76	5,0	14,2
120	100	GG	7A	120H100T	2517	485,10	483,73	-	119	462	34	45	5,5	12,1
	150	GG	9A	120H150T	2517	485,10	483,73	-	119	462	46	45	0,5	13,5
	200	GG	9A	120H200T	2517	485,10	483,73	-	119	462	60	45	7,5	15,4
	300	GG	9A	120H300T	3030	485,10	483,73	-	150	460	86	76	5,0	18,8