

**FORBORET**  
**WITH PILOT BORE**  
**VORGEBOHRT**

**L**

**3/8" (9,525 mm)**



**B2**

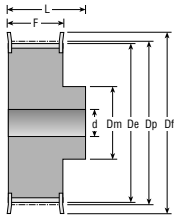

Figur 6F

Z	Rembr. Belt w. Riemenbr.	Mat.	Fig.	Best. nr. Part No. Best. Nr.	Dp	De	Df	Dm	F	L	E	d	Max. udbor. Max bore Max. Bohr.	Vægt Weight Gewicht
10	50	ST	6F	010L050N	30,32	29,59	36	22	19	26	-	6	13	0,11
	75	ST	6F	010L075N	30,32	29,59	36	22	25	32	-	6	13	0,15
	100	ST	6F	010L100N	30,32	29,59	36	22	31	38	-	6	13	0,18
12	50	ST	6F	012L050N	36,38	35,62	42	28	19	26	-	6	17	0,19
	75	ST	6F	012L075N	36,38	35,62	42	28	25	32	-	8	17	0,23
	100	ST	6F	012L100N	36,38	35,62	42	28	31	38	-	8	17	0,29
13	50	ST	6F	013L050N	39,41	38,65	44	30	19	26	-	6	19	0,21
	75	ST	6F	013L075N	39,41	38,65	44	30	25	32	-	8	19	0,26
	100	ST	6F	013L100N	39,41	38,65	44	30	31	38	-	8	19	0,30
14	50	ST	6F	014L050N	42,45	41,68	48	33	19	26	-	8	20	0,25
	75	ST	6F	014L075N	42,45	41,68	48	33	25	32	-	8	20	0,32
	100	ST	6F	014L100N	42,45	41,68	48	33	31	38	-	8	20	0,38
15	50	ST	6F	015L050N	45,48	44,72	51	36	19	26	-	8	23	0,30
	75	ST	6F	015L075N	45,48	44,72	51	36	25	32	-	8	23	0,35
	100	ST	6F	015L100N	45,48	44,72	51	36	31	38	-	8	23	0,40
16	50	ST	6F	016L050N	48,51	47,75	54	38	19	26	-	8	23	0,33
	75	ST	6F	016L075N	48,51	47,75	54	38	25	32	-	8	23	0,42
	100	ST	6F	016L100N	48,51	47,75	54	38	31	38	-	8	23	0,51
17	50	ST	6F	017L050N	51,54	50,78	57	40	19	26	-	10	24	0,36
	75	ST	6F	017L075N	51,54	50,78	57	40	25	32	-	10	24	0,45
	100	ST	6F	017L100N	51,54	50,78	57	40	31	38	-	10	24	0,54
18	50	ST	6F	018L050N	54,57	53,81	60	40	19	26	-	10	24	0,41
	75	ST	6F	018L075N	54,57	53,81	60	40	25	32	-	10	24	0,51
	100	ST	6F	018L100N	54,57	53,81	60	40	31	38	-	10	24	0,62
19	50	ST	6F	019L050N	57,61	56,84	60	40	19	26	-	10	24	0,45
	75	ST	6F	019L075N	57,61	56,84	60	40	25	32	-	10	24	0,57
	100	ST	6F	019L100N	57,61	56,84	60	40	31	38	-	10	24	0,69
20	50	ST	6F	020L050N	60,64	59,88	66	46	19	26	-	10	28	0,50
	75	ST	6F	020L075N	60,64	59,88	66	46	25	32	-	10	28	0,63
	100	ST	6F	020L100N	60,64	59,88	66	46	31	38	-	10	28	0,76
21	50	ST	6F	021L050N	63,67	62,91	71	46	19	26	-	10	28	0,55
	75	ST	6F	021L075N	63,67	62,91	71	46	25	32	-	10	28	0,70
	100	ST	6F	021L100N	63,67	62,91	71	46	31	38	-	10	28	0,82
22	50	ST	6F	022L050N	66,70	65,94	75	50	19	26	-	10	30	0,62
	75	ST	6F	022L075N	66,70	65,94	75	50	25	32	-	10	30	0,75
	100	ST	6F	022L100N	66,70	65,94	75	50	31	38	-	10	30	0,92
24	50	ST	6F	024L050N	72,77	72,00	79	50	19	26	-	12	30	0,68
	75	ST	6F	024L075N	72,77	72,00	79	50	25	32	-	12	30	0,85
	100	ST	6F	024L100N	72,77	72,00	79	50	31	38	-	12	30	1,10
26	50	ST	6F	026L050N	78,83	78,07	87	50	19	26	-	12	30	0,82
	75	ST	6F	026L075N	78,83	78,07	87	50	25	32	-	12	30	1,00
	100	ST	6F	026L100N	78,83	78,07	87	50	31	38	-	12	30	1,30
28	50	ST	6F	028L050N	84,89	84,13	91	50	19	26	-	12	30	0,92
	75	ST	6F	028L075N	84,89	84,13	91	50	25	32	-	12	30	1,20
	100	ST	6F	028L100N	84,89	84,13	91	50	31	38	-	12	30	1,40

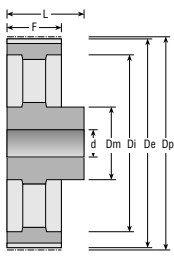
**B2****L****3/8" (9,525 mm)****FORBORET  
WITH PILOT BORE  
VORGEBOHRT**

Figur 6A

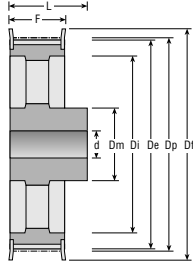

Figur 6AF

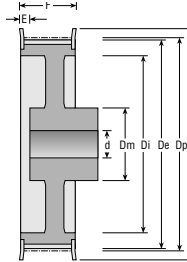

Figur 6CWF

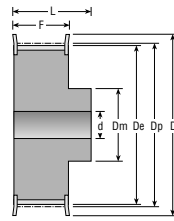

Figur 6F

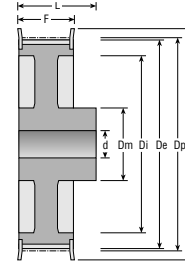

Figur 6WF

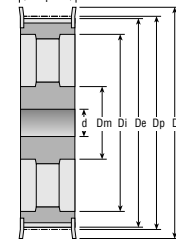

Figur 10AF

Z	Rembr. Belt w. Riemenbr.	Mat.	Fig.	Best. nr. Part No. Best. Nr.	Dp	De	Df	Dm	F	L	E	d	Max. udbor. Max bore Max. Bohr.	Vægt Weight Gewicht
30	50	ST	6F	030L050N	90,96	90,20	97	50	19	26	-	12	30	1,10
	75	ST	6F	030L075N	90,96	90,20	97	50	25	32	-	12	30	1,40
	100	ST	6F	030L100N	90,96	90,20	97	50	31	38	-	12	30	1,70
32	50	ST	6F	032L050N	97,02	96,26	103	50	19	26	-	12	30	1,20
	75	ST	6F	032L075N	97,02	96,26	103	50	25	32	-	12	30	1,50
	100	ST	6F	032L100N	97,02	96,26	103	50	31	38	-	12	30	1,80
36	50	GG	6WF	036L050N	109,15	108,39	115	50	19	26	-	12	30	1,00
	75	GG	6WF	036L075N	109,15	108,39	115	55	25	32	-	12	32	1,30
	100	GG	6CWF	036L100N	109,15	108,39	115	55	32	32	6	12	32	1,50
40	50	GG	6WF	040L050N	121,28	120,51	127	50	19	26	-	12	30	1,10
	75	GG	6WF	040L075N	121,28	120,51	127	60	25	32	-	12	35	1,60
	100	GG	6CWF	040L100N	121,28	120,51	127	60	32	32	6	12	35	1,80
44	50	GG	6AF	044L050N	133,40	132,64	140	50	19	26	-	12	30	1,20
	75	GG	6AF	044L075N	133,40	132,64	140	60	25	32	-	12	35	1,70
	100	GG	10AF	044L100N	133,40	132,64	140	60	32	-	-	12	35	1,90
48	50	GG	6AF	048L050N	145,53	144,77	152	50	19	26	-	12	30	1,30
	75	GG	6AF	048L075N	145,53	144,77	152	60	25	32	-	12	35	1,90
	100	GG	10AF	048L100N	145,53	144,77	152	60	32	-	-	12	35	2,10
60	50	GG	6A	060L050N	181,91	181,15	-	50	19	28	-	15	30	1,30
	75	GG	6A	060L075N	181,91	181,15	-	60	26	35	-	15	35	1,80
	100	GG	6A	060L100N	181,91	181,15	-	60	32	35	-	15	35	2,00
72	50	GG	6A	072L050N	218,30	217,53	-	50	19	28	-	15	30	1,70
	75	GG	6A	072L075N	218,30	217,53	-	60	26	35	-	15	35	2,30
	100	GG	6A	072L100N	218,30	217,53	-	60	32	35	-	15	35	2,50
84	50	GG	6A	084L050N	254,68	253,92	-	50	19	28	-	15	30	1,90
	75	GG	6A	084L075N	254,68	253,92	-	60	29	35	-	15	35	2,50
	100	GG	6A	084L100N	254,68	253,92	-	60	32	35	-	15	35	2,70