

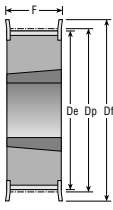

BI

**L****3/8" (9,525 mm)**

**FOR TAPER BØSNINGER**  
**FOR TAPER BUSHES**  
**FÜR TAPER BUCHSEN**



Figur 3F

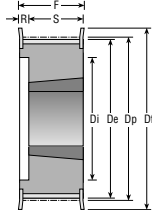

Figur 5F

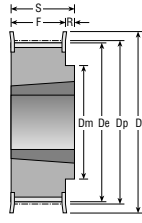

Figur 8F

Z	Rembr. Belt w. Riemenbr.	Mat.	Fig.	Best. nr. Part No. Best. Nr.	Bush	Dp	De	Df	Dm	Di	F	S	R	Vægt Weight Gewicht
18	50	ST	8F	018L050T	1108	54,57	53,81	60	44	-	19	22	3,0	0,2
	75	ST	3F	018L075T	1108	54,57	53,81	60	-	-	25	25	-	0,2
	100	ST	5F	018L100T	1108	54,57	53,81	60	-	38	31	22	9,0	0,2
19	50	ST	8F	019L050T	1108	57,61	56,84	60	44	-	19	22	3,0	0,2
	75	ST	3F	019L075T	1108	57,61	56,84	60	-	-	25	25	-	0,3
	100	ST	5F	019L100T	1108	57,61	56,84	60	-	38	31	22	9,0	0,3
20	50	ST	8F	020L050T	1108	60,64	59,88	66	48	-	19	22	3,0	0,2
	75	ST	3F	020L075T	1108	60,64	59,88	66	-	-	25	25	-	0,3
	100	ST	5F	020L100T	1108	60,64	59,88	66	-	45	31	22	9,0	0,4
21	50	ST	8F	021L050T	1108	63,67	62,91	71	48	-	19	22	3,0	0,3
	75	ST	3F	021L075T	1108	63,67	62,91	71	-	-	25	25	-	0,4
	100	ST	5F	021L100T	1108	63,67	62,91	71	-	47	31	22	9,0	0,4
22	50	ST	8F	022L050T	1108	66,70	65,94	75	51	-	19	22	3,0	0,3
	75	ST	3F	022L075T	1108	66,70	65,94	75	-	-	25	25	-	0,4
	100	ST	5F	022L100T	1108	66,70	65,94	75	-	51	31	22	9,0	0,4
23	50	GG	8F	023L050T	1108	69,73	68,97	79	54	-	19	22	3,0	0,4
	75	GG	3F	023L075T	1108	69,73	68,97	79	-	-	25	25	-	0,4
	100	GG	5F	023L100T	1108	69,73	68,97	79	-	54	32	22	10,0	0,5
24	50	GG	8F	024L050T	1108	72,77	72,00	79	54	-	19	22	3,0	0,4
	75	GG	3F	024L075T	1108	72,77	72,00	79	-	-	25	25	-	0,5
	100	GG	5F	024L100T	1108	72,77	72,00	79	-	54	32	22	10,0	0,6
25	50	GG	8F	025L050T	1108	75,80	75,04	83	56	-	19	22	3,0	0,5
	75	GG	3F	025L075T	1108	75,80	75,04	83	-	-	25	25	-	0,6
	100	GG	5F	025L100T	1108	75,80	75,04	83	-	56	32	22	10,0	0,6
26	50	GG	8F	026L050T	1108	78,83	78,07	87	60	-	19	22	3,0	0,5
	75	GG	3F	026L075T	1108	78,83	78,07	87	-	-	25	25	-	0,6
	100	GG	5F	026L100T	1108	78,83	78,07	87	-	60	32	22	10,0	0,7
27	50	GG	8F	027L050T	1108	81,86	81,10	87	65	-	19	22	3,0	0,6
	75	GG	3F	027L075T	1108	81,86	81,10	87	-	-	25	25	-	0,7
	100	GG	5F	027L100T	1108	81,86	81,10	87	-	62	32	22	10,0	0,8
28	50	GG	8F	028L050T	1108	84,89	84,13	91	65	-	19	22	3,0	0,6
	75	GG	3F	028L075T	1108	84,89	84,13	91	-	-	25	25	-	0,7
	100	GG	5F	028L100T	1108	84,89	84,13	91	-	65	32	22	10,0	0,8
30	50	GG	8F	030L050T	1108	90,96	90,20	97	70	-	19	22	3,0	0,8
	75	GG	3F	030L075T	1108	90,96	90,20	97	-	-	25	25	-	0,9
	100	GG	5F	030L100T	1210	90,96	90,20	97	-	71	32	25	7,0	0,9
32	50	GG	8F	032L050T	1108	97,02	96,26	103	74	-	19	22	3,0	0,9
	75	GG	3F	032L075T	1108	97,02	96,26	103	-	-	25	25	-	1,0
	100	GG	5F	032L100T	1210	97,02	96,26	103	-	75	32	25	7,0	1,0
36	50	GG	8F	036L050T	1108	109,15	108,39	115	87	-	19	22	3,0	1,2
	75	GG	3F	036L075T	1610	109,15	108,39	115	-	-	25	25	-	1,2
	100	GG	5F	036L100T	1610	109,15	108,39	115	-	89	32	25	7,0	1,4
40	50	GG	8F	040L050T	1610	121,28	120,51	127	97	-	19	25	6,0	1,5
	75	GG	3F	040L075T	1610	121,28	120,51	127	-	-	25	25	-	1,7
	100	GG	5F	040L100T	1610	121,28	120,51	127	-	101	32	25	7,0	1,7

**FOR TAPER BØSNINGER  
FOR TAPER BUSHES  
FÜR TAPER BUCHSEN**

**L**



**3/8" (9,525 mm)**

**BI**

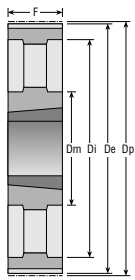

Figur 3A

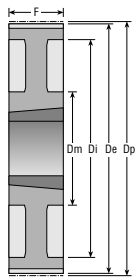

Figur 3W

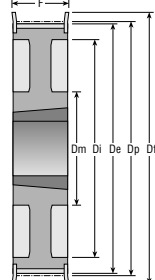

Figur 3WF

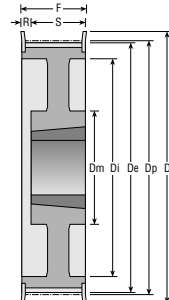

Figur 5WF

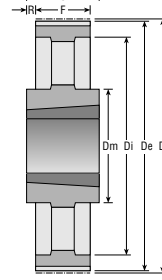

Figur 7A

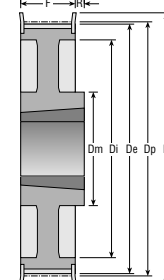

Figur 8WF

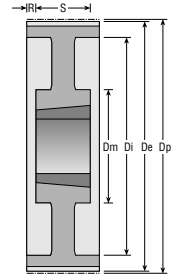

Figur 9W

Z	Rembr. Belt w. Riemenbr.	Mat.	Fig.	Best. nr. Part No. Best. Nr.	Bush	Dp	De	Df	Dm	Di	F	S	R	Vægt Weight Gewicht
48	50	GG	8WF	048L050T	1610	145,53	144,77	152	88	124	19	25	6,0	2,3
	75	GG	3WF	048L075T	1610	145,53	144,77	152	92	124	25	25	-	2,5
	100	GG	5WF	048L100T	1610	145,53	144,77	152	92	124	32	25	7,0	2,7
60	50	GG	7A	060L050T	1610	181,91	181,15	-	92	166	19	25	3,0	2,0
	75	GG	3W	060L075T	1610	181,91	181,15	-	92	166	25	25	-	3,0
	100	GG	9W	060L100T	1610	181,91	181,15	-	92	166	32	25	3,5	2,4
72	50	GG	7A	072L050T	1610	218,30	217,53	-	92	202	19	25	3,0	3,0
	75	GG	3A	072L075T	1610	218,30	217,53	-	92	202	25	25	-	4,0
	100	GG	3A	072L100T	2012	218,30	217,53	-	106	202	32	32	-	4,4
84	50	GG	7A	084L050T	1610	254,68	253,92	-	92	236	19	25	3,0	4,0
	75	GG	7A	084L075T	2012	254,68	253,92	-	106	236	25	32	3,5	5,2
	100	GG	3A	084L100T	2012	254,68	253,92	-	106	236	32	32	-	6,0
96	50	GG	7A	096L050T	2012	291,06	290,30	-	106	270	19	32	6,5	5,5
	75	GG	7A	096L075T	2012	291,06	290,30	-	106	270	25	32	3,5	6,5
	100	GG	3A	096L100T	2012	291,06	290,30	-	106	270	32	32	-	7,1
120	50	GG	7A	120L050T	2012	363,83	363,07	-	106	343	19	32	6,5	6,8
	75	GG	7A	120L075T	2012	363,83	363,07	-	106	343	25	32	3,5	7,6
	100	GG	3A	120L100T	2012	363,83	363,07	-	106	343	32	32	-	8,5