

# Kolv

## PWR-PF

### Typ PWR-PF

Styrning av Vävplast för kolv.

Spalten på var sida om tätningen avgörs av tätningstyp, temperatur, hastighet och tryckförhållanden, se 1) i inbyggnadsanvisningen.

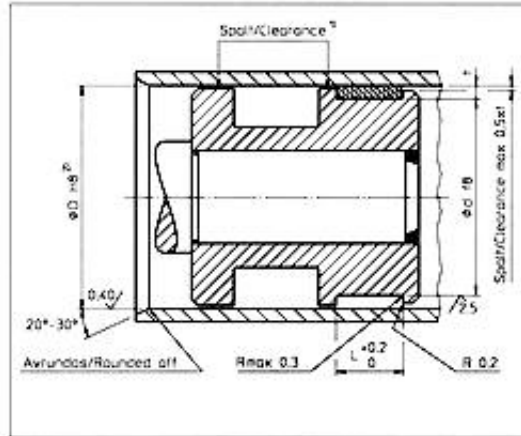

Æ D	Æ d	L	Benämning	Æ D	Æ d	L	Benämning
35,0	29,0	10,0	PWR 35/29x10,0-PF	140,0	134,0	13,0	PWR 140/134x13,0-PF
40,0	34,0	10,0	PWR 40/34x10,0-PF	140,0	134,0	20,0	PWR 140/134x20,0-PF
40,0	35,0	9,7	PWR 40/35x9,7-PF	140,0	134,0	25,0	PWR 140/134x25,0-PF
40,0	36,0	8,1	PWR 40/36x8,1-PF	140,0	134,0	30,0	PWR 140/134x30,0-PF
45,0	39,0	10,0	PWR 45/39x10,0-PF	140,0	135,0	15,0	PWR 140/135x15,0-PF
50,0	44,0	10,0	PWR 50/44x10,0-PF	145,0	139,0	30,0	PWR 145/139x30,0-PF
50,0	45,0	6,3	PWR 50/45x6,3-PF	150,0	144,0	13,0	PWR 150/144x13,0-PF
50,0	45,0	9,7	PWR 50/45x9,7-PF	150,0	144,0	20,0	PWR 150/144x20,0-PF
55,0	50,0	25,0	PWR 55/50x25,0-PF	150,0	144,0	25,0	PWR 150/144x25,0-PF
60,0	54,0	13,0	PWR 60/54x13,0-PF	150,0	144,0	30,0	PWR 150/144x30,0-PF
60,0	54,0	20,0	PWR 60/54x20,0-PF	150,0	144,0	40,0	PWR 150/144x40,0-PF
60,0	55,0	6,3	PWR 60/55x6,3-PF	150,0	145,0	15,0	PWR 150/145x15,0-PF
63,0	57,0	13,0	PWR 63/57x13,0-PF	160,0	154,0	13,0	PWR 160/154x13,0-PF
63,0	58,0	6,3	PWR 63/58x6,3-PF	160,0	154,0	15,0	PWR 160/154x15,0-PF

							PF
63,0	58,0	9,7	PWR 63/58x9,7-PF	160,0	154,0	19,5	PWR 160/154x19,5-PF
65,0	59,0	15,0	PWR 65/59x15,0-PF	160,0	154,0	20,0	PWR 160/154x20,0-PF
70,0	64,0	13,0	PWR 70/64x13,0-PF	160,0	154,0	25,0	PWR 160/154x25,0-PF
70,0	65,0	20,0	PWR 70/65x20,0-PF	160,0	154,0	30,0	PWR 160/154x30,0-PF
75,0	69,0	25,0	PWR 75/69x25,0-PF	160,0	154,0	50,0	PWR 160/154x50,0-PF
80,0	74,0	13,0	PWR 80/74x13,0-PF	160,0	155,0	15,0	PWR 160/155x15,0-PF
80,0	74,0	25,0	PWR 80/74x25,0-PF	170,0	160,0	20,0	PWR 170/160x20,0-PF
80,0	75,0	15,0	PWR 80/75x15,0-PF	170,0	164,0	19,5	PWR 170/164x19,5-PF
80,0	75,0	9,7	PWR 80/75x9,7-PF	170,0	164,0	20,0	PWR 170/164x20,0-PF
85,0	79,0	13,0	PWR 85/79x13,0-PF	170,0	164,0	30,0	PWR 170/164x30,0-PF
90,0	84,0	13,0	PWR 90/84x13,0-PF	180,0	172,0	40,0	PWR 180/172x40,0-PF
90,0	85,0	9,7	PWR 90/85x9,7-PF	180,0	174,0	13,0	PWR 180/174x13,0-PF
95,0	89,0	13,0	PWR 95/89x13,0-PF	180,0	174,0	19,5	PWR 180/174x19,5-PF
100,0	94,0	13,0	PWR 100/94x13,0-PF	180,0	174,0	30,0	PWR 180/174x30,0-PF
100,0	94,0	20,0	PWR 100/94x20,0-PF	180,0	175,0	10,0	PWR 180/175x10,0-PF
100,0	94,0	25,0	PWR 100/94x25,0-PF	200,0	194,0	20,0	PWR 200/194x20,0-PF
100,0	95,0	9,7	PWR 100/95x9,7-PF	200,0	194,0	30,0	PWR 200/194x30,0-PF
100,0	95,0	15,0	PWR 100/95x15,0-PF	200,0	194,0	50,0	PWR 200/194x50,0-PF
110,0	104,0	13,0	PWR 110/104x13,0-PF	200,0	195,0	15,0	PWR 200/195x15,0-PF
110,0	104,0	40,0	PWR 110/104x40,0-PF	220,0	212,0	30,0	PWR 220/212x30,0-PF
115,0	109,0	25,0	PWR 115/109x25,0-PF	220,0	214,0	19,5	PWR 220/214x19,5-PF
120,0	114,0	13,0	PWR 120/114x13,0-PF	220,0	214,0	25,0	PWR 220/214x25,0-PF
120,0	114,0	19,5	PWR 120/114x19,5-PF	250,0	242,0	25,0	PWR 250/242x25,0-PF

120,0	114,0	20,0	PWR 120/114x20,0-PF	270,0	262,0	40,0	PWR 270/262x40,0-PF
120,0	114,0	40,0	PWR 120/114x40,0-PF	280,0	272,0	30,0	PWR 280/272x30,0-PF
120,0	115,0	9,7	PWR 120/115x9,7-PF	280,0	274,0	40,0	PWR 280/274x40,0-PF
125,0	119,0	13,0	PWR 125/119x13,0-PF	290,0	282,0	25,0	PWR 290/282x25,0-PF
125,0	119,0	15,0	PWR 125/119x15,0-PF	300,0	292,0	40,0	PWR 300/292x40,0-PF
125,0	119,0	20,0	PWR 125/119x20,0-PF	320,0	312,0	25,0	PWR 320/312x25,0-PF
125,0	119,0	25,0	PWR 125/119x25,0-PF	380,0	372,0	25,0	PWR 380/372x25,0-PF
125,0	119,0	40,0	PWR 125/119x40,0-PF	400,0	392,0	30,0	PWR 400/392x30,0-PF
125,0	120,0	9,7	PWR 125/120x9,7-PF	490,0	485,0	15,0	PWR 490/485x15,0-PF
130,0	124,0	30,0	PWR 130/124x30,0-PF	830,0	820,0	90,0	PWR 830/820x90,0-PF
135,0	129,0	13,0	PWR 135/129x13,0-PF				