

Stångtätning

Typ TSL



Typ TS/L

Polyuretan med sekundär tätegg.

= ISO-dimension

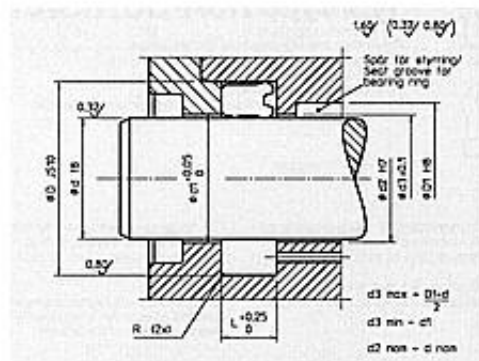

Æ d	Æ d ₁	Æ D	L	Benämning	ISO
16,0	16,2	24,0	6,3	TS/L 16/24x5,7	ISO
16,0	16,2	24,0	7,0	TS/L 16/24x6,3	
20,0	20,2	28,0	6,3	TS/L 20/28x5,7	ISO
20,0	20,2	30,0	8,0	TS/L 20/30x7,2	ISO
25,0	25,2	33,0	6,3	TS/L 25/33x5,7	ISO
25,0	25,2	35,0	8,0	TS/L 25/35x7,2	
25,0	25,2	35,0	9,0	TS/L 25/35x8,0	
28,0	28,2	38,0	8,0	TS/L 28/38x7,2	ISO
30,0	30,2	40,0	8,0	TS/L 30/40x7,2	
32,0	32,2	40,0	9,0	TS/L 32/40x8,0	
32,0	32,2	42,0	8,0	TS/L 32/42x7,2	ISO
35,0	35,2	45,0	8,0	TS/L 35/45x7,2	
35,0	35,2	50,0	11,0	TS/L 35/50x10,0	
38,0	38,2	50,0	9,5	TS/L 38/50x8,5	ISO
40,0	40,2	50,0	8,0	TS/L 40/50x7,2	ISO
40,0	40,2	50,0	11,0	TS/L 40/50x10,0	
40,0	40,2	60,0	11,0	TS/L 40/60x10,0	
45,0	45,2	53,0	9,0	TS/L 45/53x8,0	
45,0	45,2	55,0	8,0	TS/L 45/55x7,2	ISO
50,0	50,2	60,0	8,0	TS/L 50/60x7,2	ISO
50,0	50,2	60,0	11,0	TS/L 50/60x10,0	

50,0	50,2	62,7	10,5	TS/L 50/62,7x9,5	
75,0	75,2	85,0	13,0	TS/L 75/85x12,0	